

# Artemide®

## SYLT VECTOR 30 - 40

design  
Carlotta de Bevilacqua

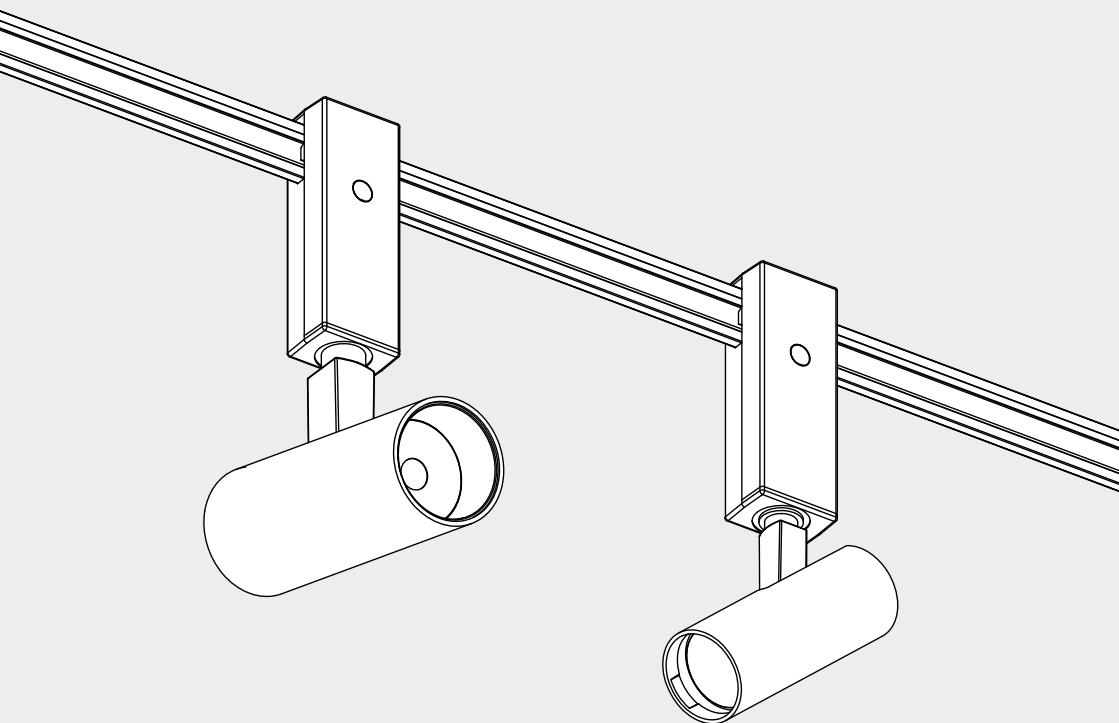



i

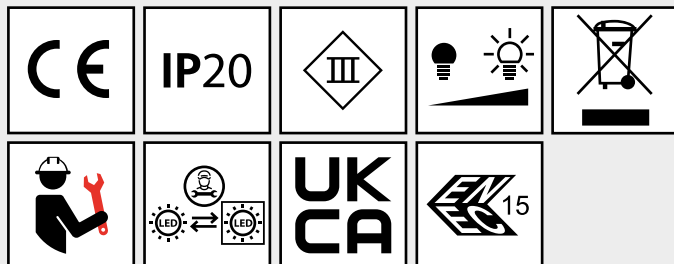

VECTOR 30/40

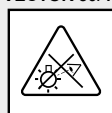

VECTOR 30

	LED1 from Dthr (m)		
	2700K	3000K	4000K
SP	LED1	LED1	1,66
FL	LED1	LED1	1,4
WF	LED1	LED1	1,4

VECTOR 40

	LED1 from Dthr (m)		
	2700K	3000K	4000K
SP	1,6	1,6	2,15
FL	LED1	LED1	1,75
WF	LED1	LED1	1,75

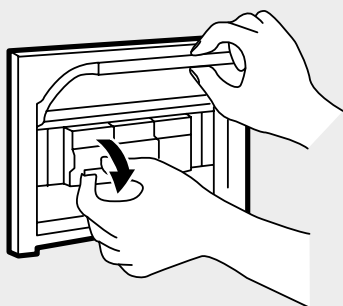
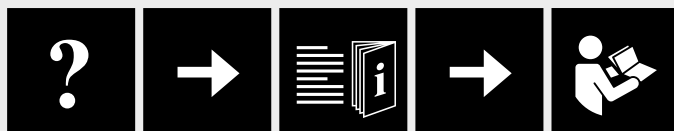

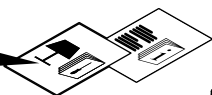

VECTOR 40

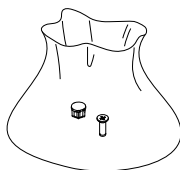

VECTOR 30

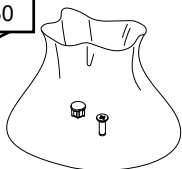
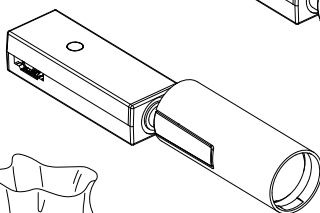

1

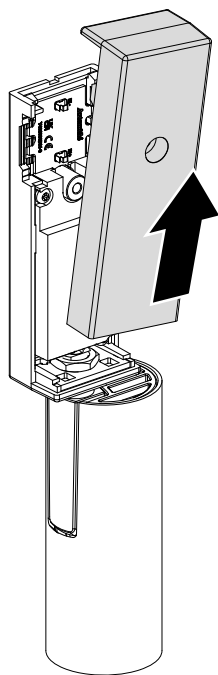
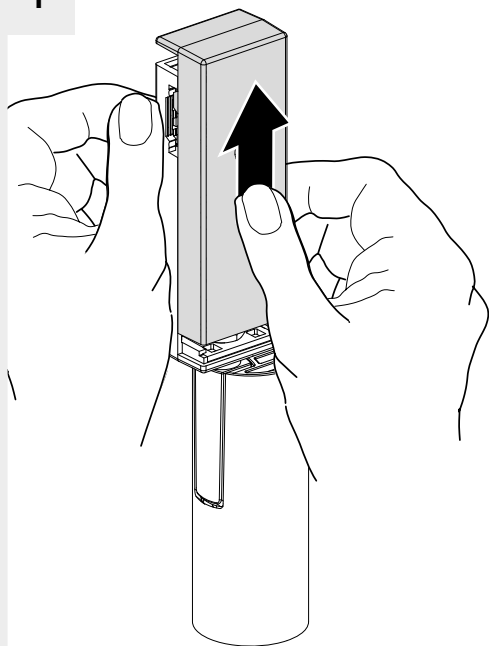

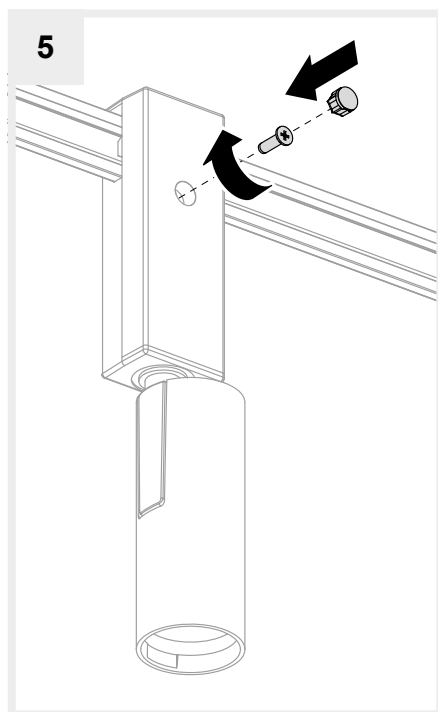
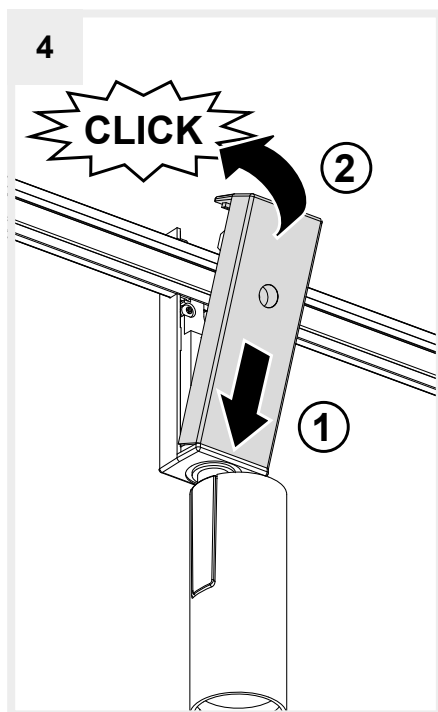
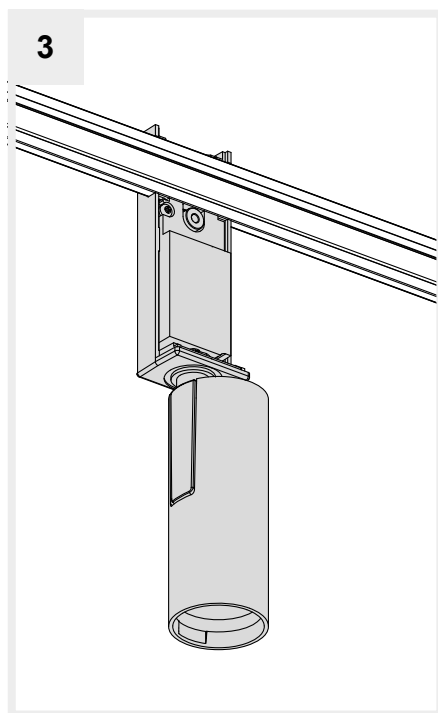
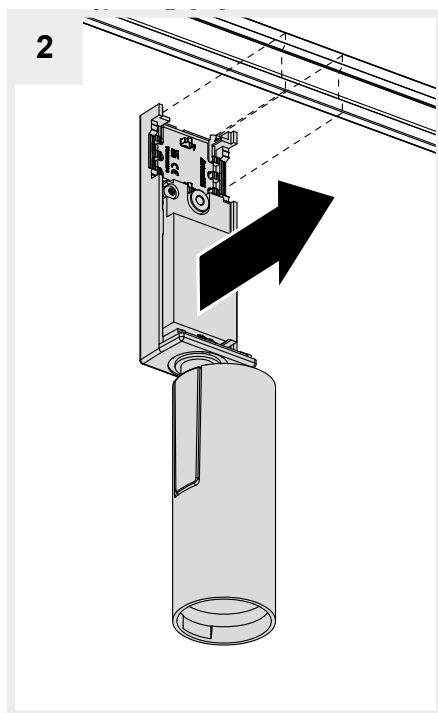

**i**

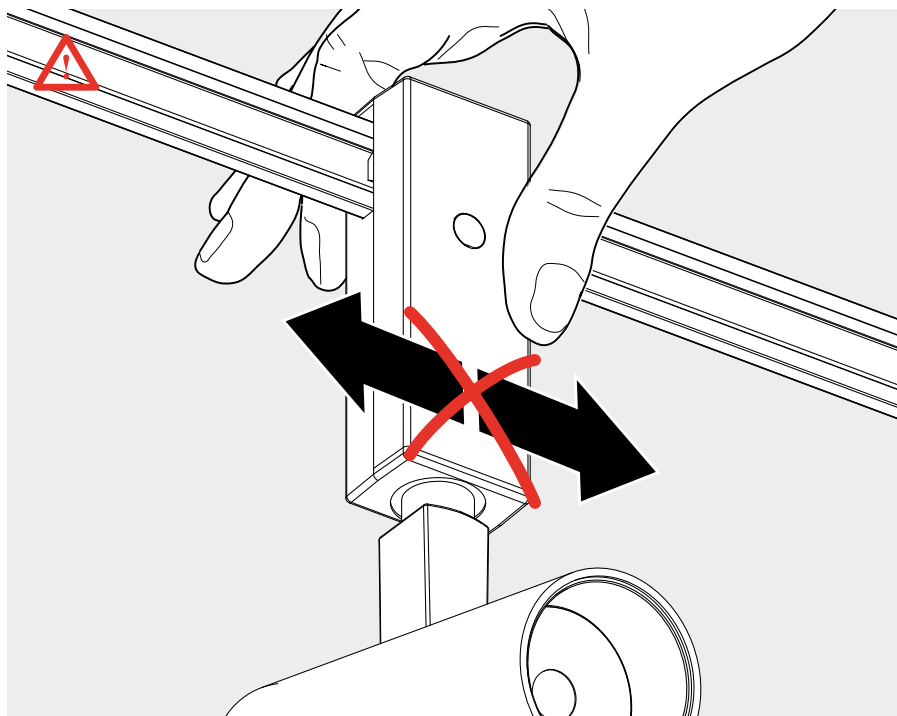
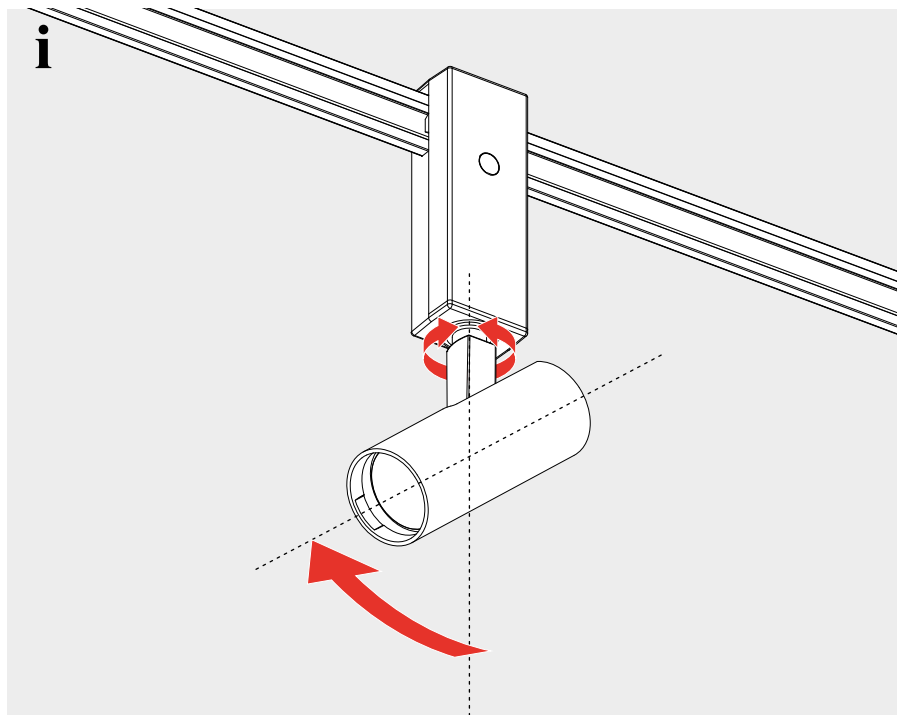

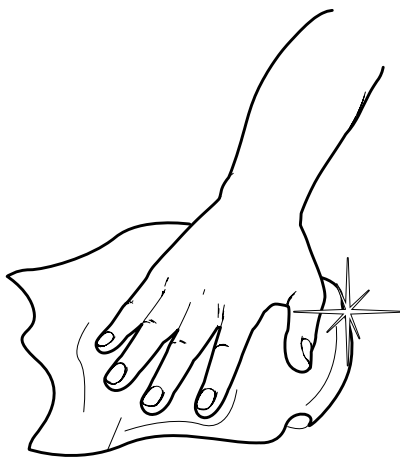
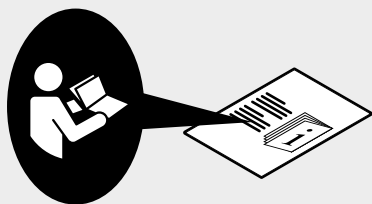
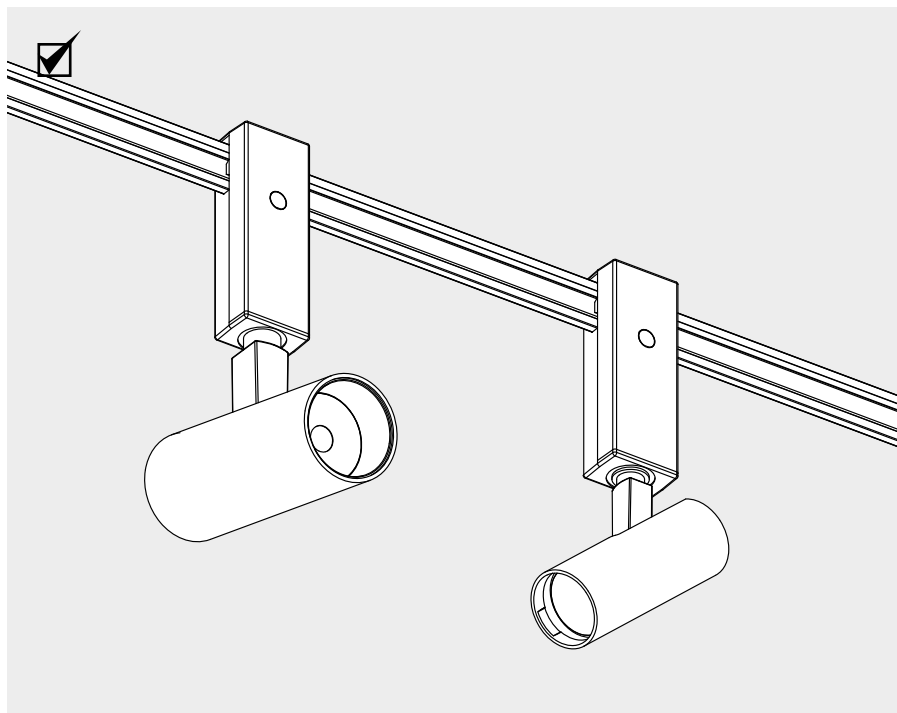

# VECTOR 40 ACCESSORIES

1

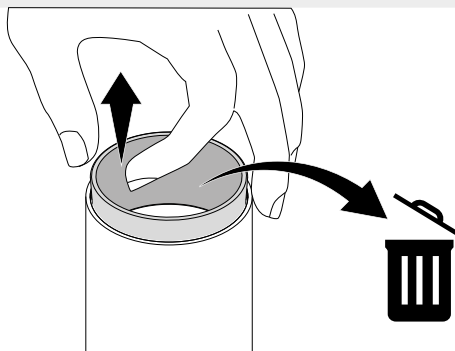

AP9X100

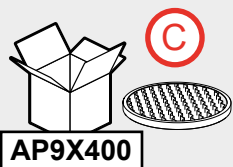
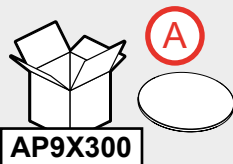
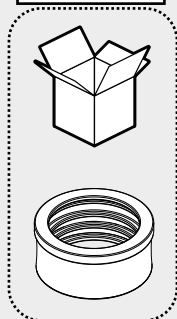

2

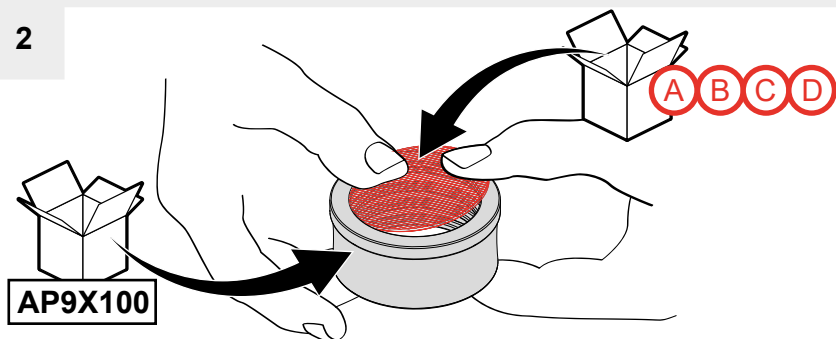

# VECTOR 40 ACCESSORIES

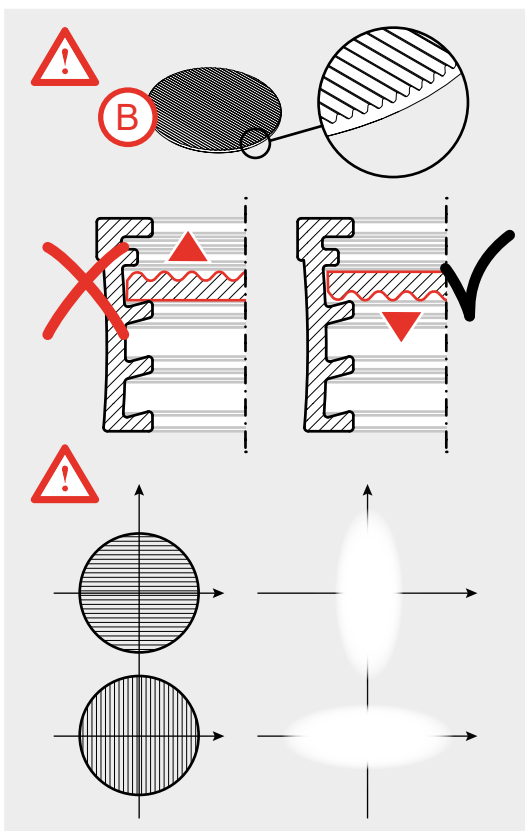
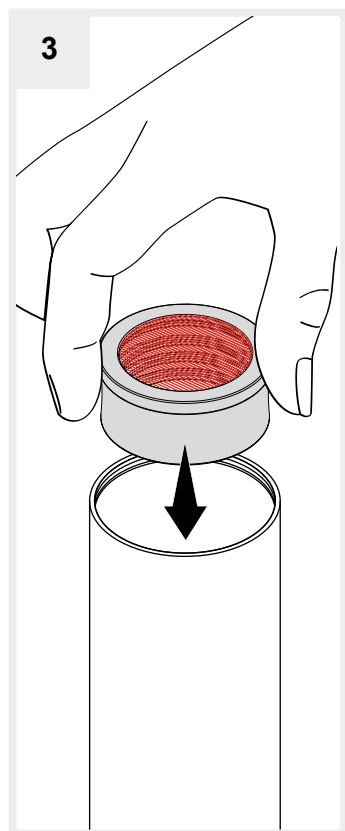
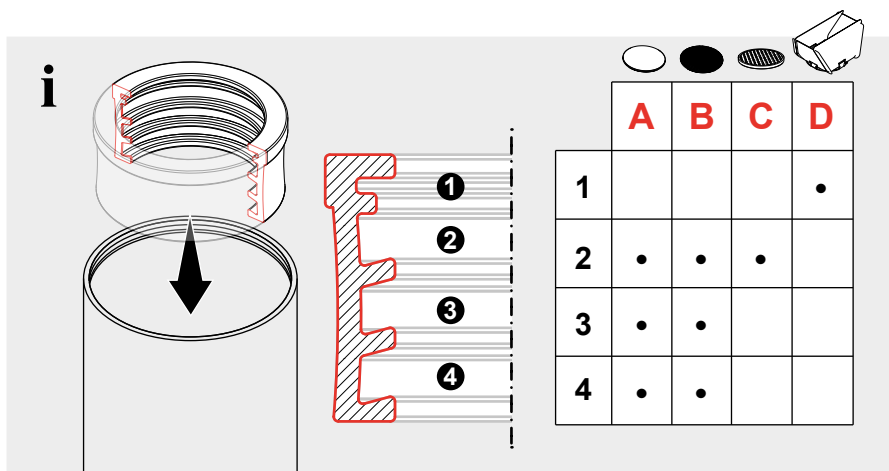









**Artemide®**

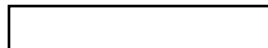

**Artemide**

via Bergamo, 18  
20006 Pregnana M.se (MI)  
ITALIA

tel. +39 02 935 181  
fax +39 02 935 90 254  
fax +39 02 935 90 496

[www.artemide.com](http://www.artemide.com)

VAT IT00846890150

**Artemide Inc.**

250 Karin Lane  
Hicksville, NY 11801

tel. 631 694 9292  
Toll Free 1-877-Art-9111  
Fax 631 694 9275

[www.artemide.net](http://www.artemide.net)

cod. Y513002132B